

Saalpläne

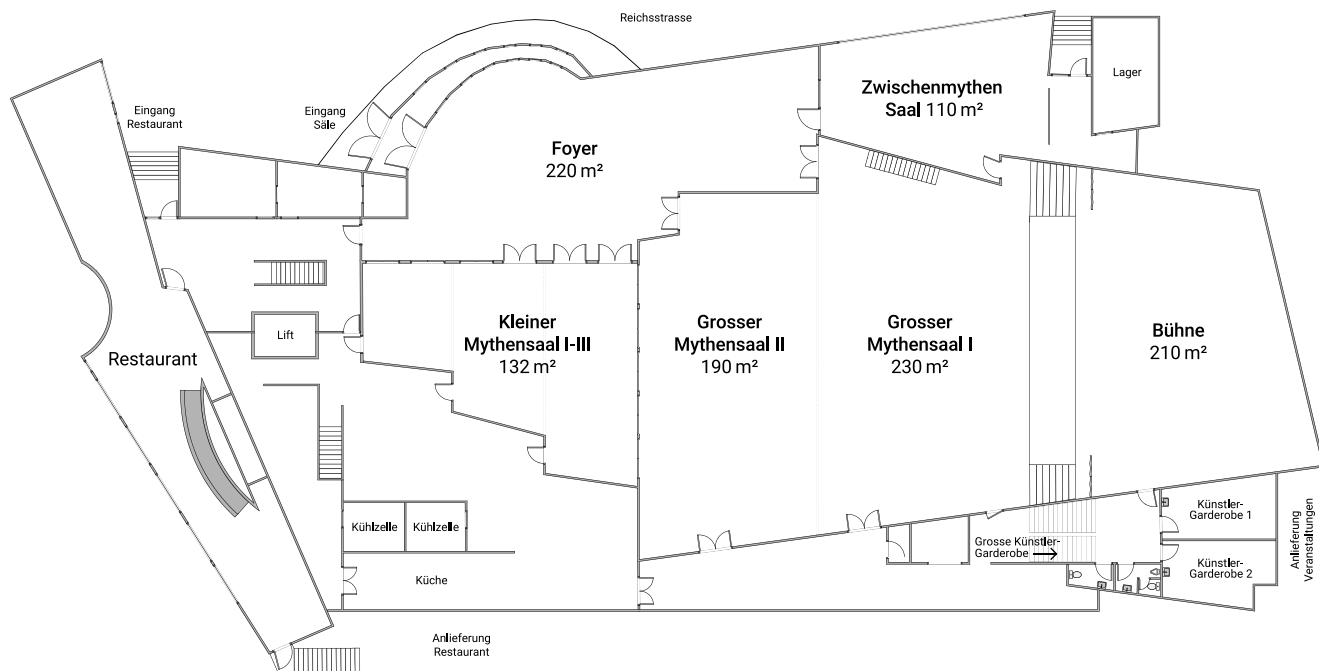

Grosser Mythensaal

Bankett eckig

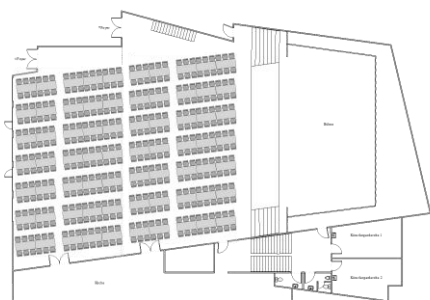

Max. Personen: 210 (GM I), 420 (GM I+II)

Bankett rund

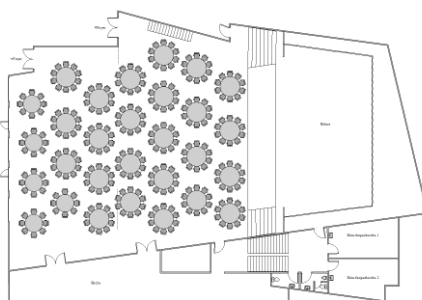

Max. Personen: 140 (GM I), 240 (GM I+II)

Konzert & Theater

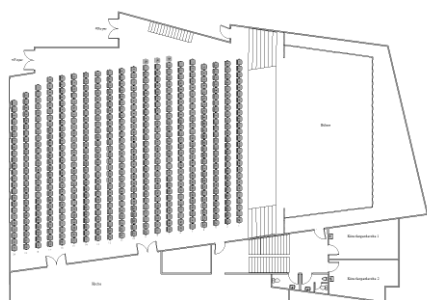

Max. Personen: 266 (GM I), 566 (GM I+II)

Konzert & Theater mit Tribüne

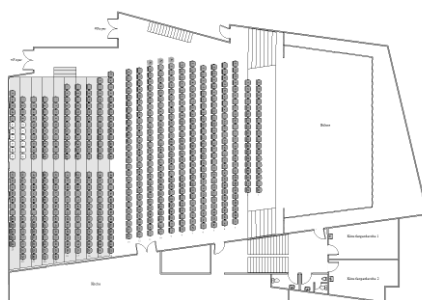

Max. Personen: 576 (GM I+II)

Parlamentarisch / Kongress

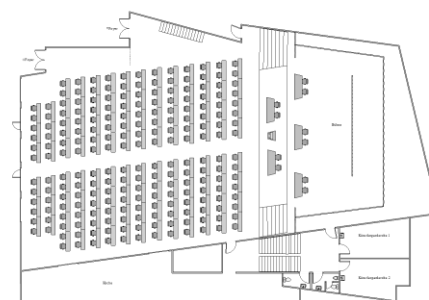

Max. Personen: 118 (GM I), 220 (GM I+II)

Kleiner Mythensaal

Bankett eckig

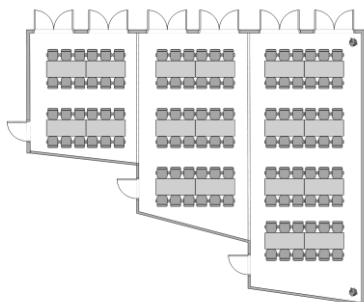

Max. Personen: 108

Bankett rund

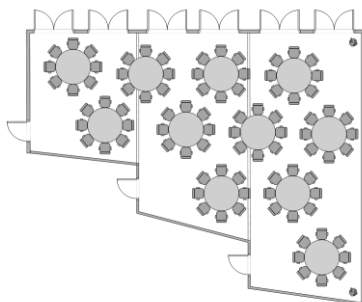

Max. Personen: 88

Seminar U-Form

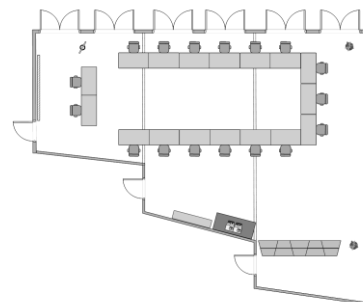

Max. Personen: 34

Konzert & Theater

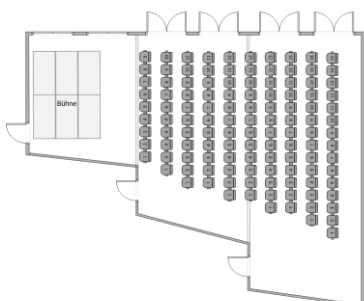

Max. Personen: 120

Seminar O-Form

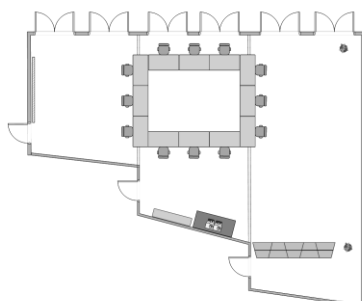

Max. Personen: 30

Zwischenmythen Saal

Seminar U-Form

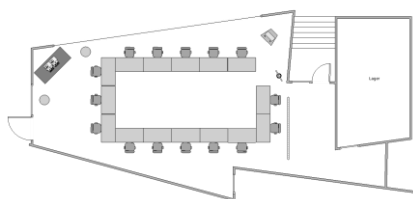

Max. Personen: 30

Seminar O-Form / Sitzungsblock

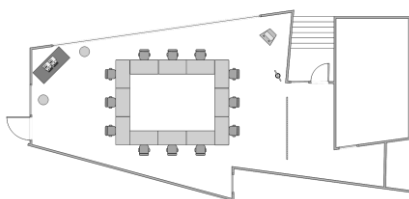

Max. Personen: 24

Fischgrat

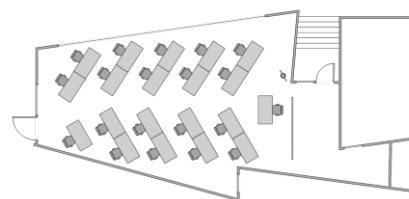

Max. Personen: 40

Saalkombinationen

Individuell

